

Simplicity[®]

*(The chances are you're
never going to read me)*

Owner's Manual

Jill



www.simplicityvac.com

Simplicity[®]

The vacuum you'll *flip* over.™

IMPORTANT SAFETY INSTRUCTIONS

When using an electrical appliance, basic precautions should always be followed, including the following:

READ ALL INSTRUCTIONS BEFORE USING THIS APPLIANCE

WARNING: The manufacturer cannot accept responsibility for damage caused when the appliance is not used according to the instructions, or for uses other than those for which it was intended.

To reduce the risk of fire, electric shock or injury:

- Do not leave appliance when plugged in. Unplug from outlet when not in use and before servicing.
- Do not handle plug or appliance with wet hands.
- **WARNING: ELECTRIC SHOCK COULD OCCUR IF USED OUTDOORS OR ON WET SURFACES.**
- Do not put any object into openings. Do not use with any opening blocked; keep free of dust, lint, hair and anything that may reduce air flow.
- Do not allow to be used as a toy. Close attention is necessary when used by or near children.
- Keep hair, loose clothing, fingers and all parts of body away from openings and moving parts.
- Use only as described in this manual. Use only manufacturer's recommended attachments.
- Do not pick up anything that is burning or smoking, such as cigarettes, matches or hot ashes.
- Do not use with damaged cord or plug. If appliance is not working as it should, has been dropped, damaged, left outdoors, or dropped into water, return it to your Authorized Retailer for service.
- Do not use without vacuum bag in place.
- Turn off all controls before unplugging.
- Use extra care when cleaning on stairs.
- Do not pull or carry by cord, use cord as a handle, close a door on the cord, or pull cord around sharp edges or corners. Do not run appliance over cord. Keep cord away from heated surfaces.
- Do not use to pick up flammable or combustible liquids such as gasoline or use in areas where they may be present.
- Do not unplug by pulling on cord. To unplug, grasp the plug, not the cord.
- Do not attempt to service the unit while appliance is plugged in.
- Hold plug when rewinding the power cord to prevent the cord from whipping.
- Do not use vacuum to pick up water or any wet materials.

SAVE THESE INSTRUCTIONS.

Contents

Safety Precautions 4

Replacing Vacuum Bag and Filters..... 5

Description and Operation 6-7

Troubleshooting Guide 8

Owner's Information..... 9

Warranty..... 10

Safety Precautions

This vacuum cleaner should be used for normal, dry household dust and dirt. The manufacturer cannot be held responsible for any damage caused by use or operation of the vacuum contrary to these instructions. If the vacuum is wrongly operated for a purpose other than that for which it is intended, no liability can be accepted for any possible damage.

- Do not vacuum areas which contain moisture or water, flammable matter, needles, pins, razor blades, matches, cigarettes, etc., since they may damage the vacuum or vacuum bag.
- When rewinding the power cord, hold the plug before pressing the cord rewind button to prevent the cord from whipping.
- Make sure a vacuum bag and filters are always in place.
- This product is equipped with a polarized alternating current line plug (a plug having one blade wider than the other). This plug fits into the power outlet only one way. This is a safety feature. If you are unable to insert the plug fully into the outlet, try reversing the plug. If the plug should still fail to fit, contact an electrician to replace the obsolete outlet. Do not defeat the safety purpose of the polarized plug.

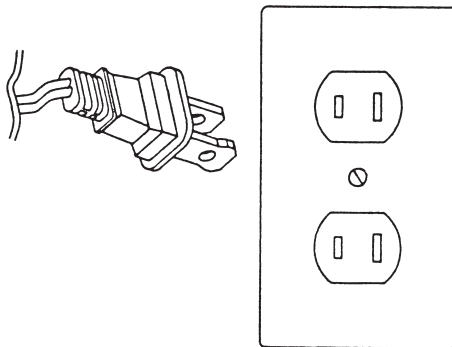

Replacing Vacuum Bag and Filters

Replacing the vacuum bag

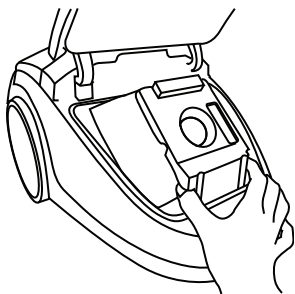

Change the vacuum bag when the indicator is RED or suction power is weak. The dust cover will not close without a bag in the unit or if the bag is not properly installed.

1. Pull the bag holder straight out to access the bag.
2. Remove and discard the used bag. NOTE: The HiFlow™ HEPA bag cannot be reused. Do not throw away the bag holder.
3. Secure the new bag with the bag collar holder latch. Slide the tab on the bag holder into the slot on the front of the bag compartment.

Replacing the secondary filter

1. Open the bag compartment and locate the filter behind the vacuum bag. For better access to the secondary filter, remove the bag holder and bag.
2. Slide filter holder up and out.
3. Remove the used filter and replace it with a new filter.
4. Slide the filter holder back in place and replace the bag holder and bag.

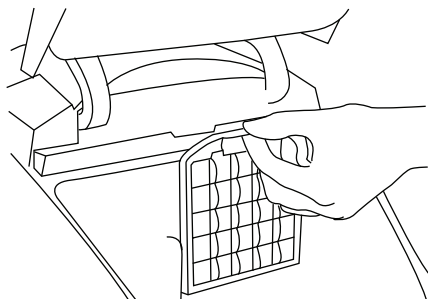

Replacing the HiFlow HEPA filter

1. Locate the HiFlow HEPA filter inside the bag compartment near the door hinge.
2. Press the black tab to remove the used filter and snap in a new filter. NOTE: The HiFlow HEPA filter cannot be washed and reused.

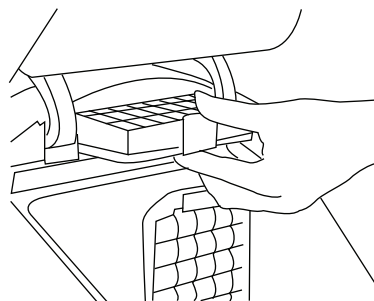

Description and Operation

Hose Adapter

- When separating the hose from the canister body, pull the hose adapter while pressing the buttons.

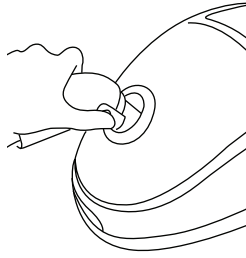

Storage

- Insert the tab on the neck of the wand into either groove on canister body to store the wand.

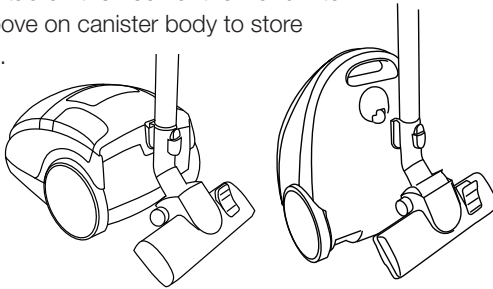

Hard Surface Floor Tool

- For use on tile, hard wood and linoleum floors.

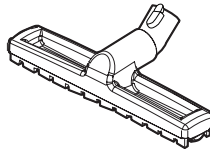

Rug/Floor Tool

Expose bristles for bare floor cleaning

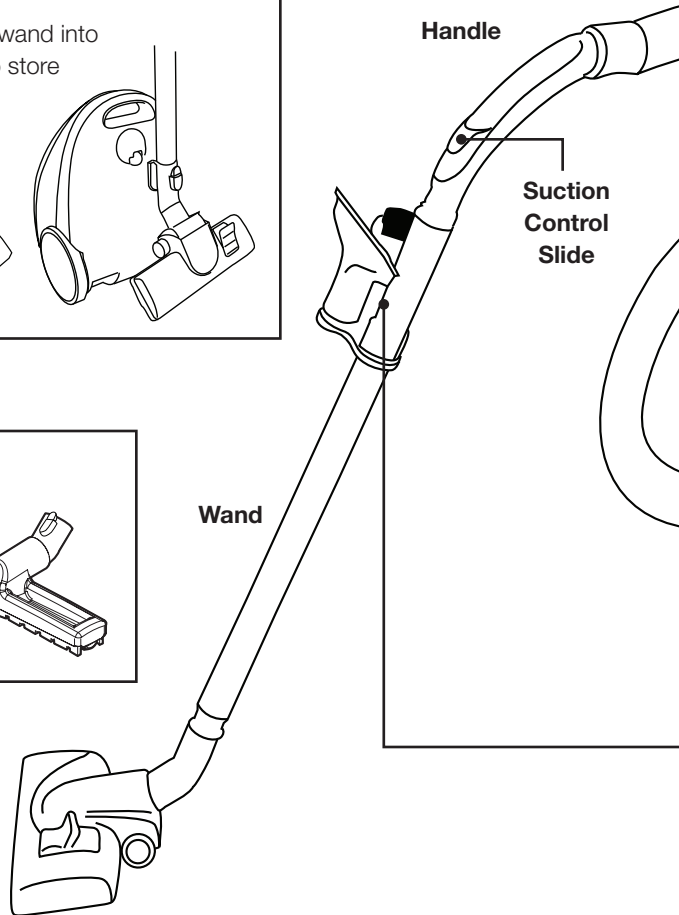

Full Bag Indicator

- If the red indicator appears:
 - Change the vacuum bag
 - If the vacuum bag is not full and the full bag indicator is red, check the hose for a clog.
- When cleaning with a tool (dusting brush, upholstery tool or crevice tool), the red indicator may appear. In this case, continue cleaning.

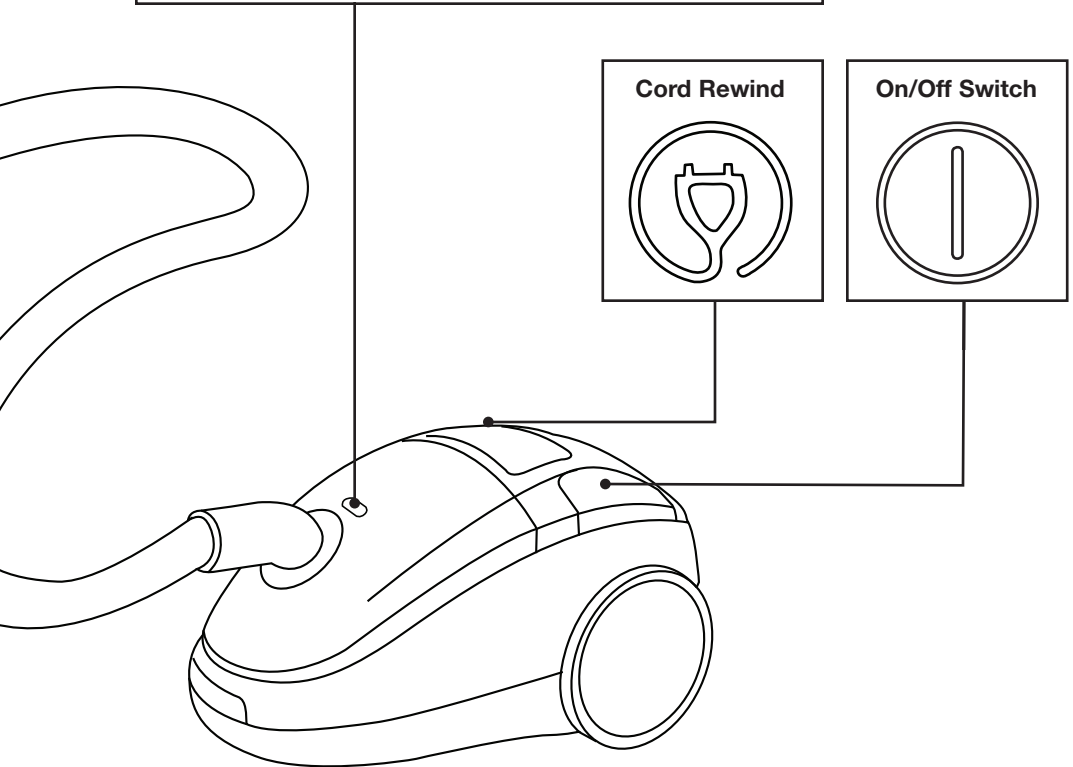

Cleaning Tools

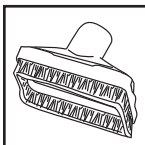

Dusting
Brush

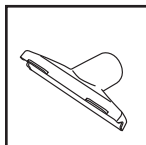

Upholstery
Tool

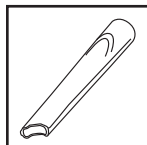

Crevice
Tool

Troubleshooting Guide

Please check each item below if you have trouble with your vacuum.
Unplug the vacuum from the power supply before servicing.

Problem	Check Point	Possible Solution
Suction power is weak.	Vacuum bag Wand or hose	If vacuum bag is full, replace it. If clogged or blocked, remove the object.
The vacuum does not work.	Is the hose adapter inserted into the suction opening of the vacuum completely? When the vacuum bag is full or any of the accessories are blocked, the over-heating protection for the motor is activated and automatically shuts down the vacuum.	Insert it completely. Turn the vacuum off and unplug the vacuum. Check the vacuum bag and accessories and remove any blockages. The vacuum can be turned on again after approximately 20 minutes.
Power cord does not rewind.	Power cord	Pull the power cord out a little and press the cord rewind button again.
Power cord won't pull out of the vacuum.	Power cord	Do not pull it out by force. Rewind it a little by pressing the cord rewind button and try pulling it out again.

Specifications

Model: JILL.1
Rating: 120V/60Hz
Amps: 9

Owner's Information (keep this for your records)

The model and serial number of this product may be found on the back side of the unit. You should note the model and serial number of your unit in the spaces provided below, and retain this book as a permanent record of your purchase.

Date of purchase _____

Serial number _____

Model number _____

Purchased from:

Store name _____

Address _____

City, State, Zip _____

Telephone _____

For Best Performance:

- Keep your canister clean and in good operating condition.
- Change vacuum bags once a month or when the bag is 2/3 full to maximize cleaning performance.
- Always use genuine vacuum bags and replacement parts. Use of other products may result in poor cleaning performance, potential vacuum cleaner damage and may void vacuum warranty. Genuine products are designed for maximum cleaning performance.
- Have your canister checked periodically by your Authorized Simplicity Retailer.
- Use only Authorized Simplicity Retailers for parts or service.
- Store your canister carefully in a dry area.
- For optimum cleaning performance and safety, follow your owner's manual instructions.

Warranty

What is Covered:

This warranty covers any defects in material and workmanship in your new Simplicity vacuum and applies exclusively to the original purchaser.

How Long Coverage Lasts:

Warranty coverage for the Simplicity Jill canister lasts two years. Household models used commercially are only warranted for 90 days.

What is Not Covered:

- Damage to the vacuum which occurs from neglect, abuse, alterations, accident, misuse or improper maintenance.
- Normal replacement items: filters and disposable bags.

What Simplicity Will Do:

This warranty provides, at no cost to you, all labor and parts to place this vacuum in correct operating condition during the warranted period.

How to Get Service:

Warranty service can only be obtained by presenting the vacuum to an Authorized Simplicity Retailer. A proof-of-purchase and product serial number will be required before service is rendered. To locate your nearest Simplicity Retailer, please call 1-888-9-SIMPLY or visit the Simplicity website at www.simplicityvac.com.

THIS WARRANTY IS EXCLUSIVE AND IN LIEU OF ANY AND ALL OTHER WARRANTIES WHETHER WRITTEN, ORAL, EXPRESSED OR IMPLIED, (INCLUDING ANY WARRANTY OF MERCHANTABILITY OR FITNESS FOR A PARTICULAR PURPOSE). THIS WARRANTY DISCLAIMS LIABILITY FOR INCIDENTAL, OR CONSEQUENTIAL DAMAGES.

How State Law Applies:

This warranty gives you specific legal rights, and you may also have other rights which vary from state to state.

Simplicity[®]
The vacuum you'll *flip* over.[™]

www.simplicityvac.com